

3FFH

4BD4FH

ISO A - ISO B - Standard
ISO A - ISO B - Standard
ISO A - ISO B - Standard
ISO A - ISO B - Standard

ISO A - ISO B - Standard
ISO A - ISO B - Standard
ISO A - ISO B - Standard
ISO A - ISO B - Standard

Agriculture
Agricoltura
Ausführung Agritechnik
Agriculture

Agriculture
Agricoltura
Ausführung Agritechnik
Agriculture

Screw Together
Innesti a Vite
Schraubkupplungen
A Visser

Screw Together
Innesti a Vite
Schraubkupplungen
A Visser

Check Valves
Valvole Unidirezionali
Rückschläventile
Clapet Anti-retour

Check Valves
Valvole Unidirezionali
Rückschläventile
Clapet Anti-retour

Diagnostic
Diagnostici
Diagnostik Kupplung
Diagnostic

Diagnostic
Diagnostici
Diagnostik Kupplung
Diagnostic

Flat Face
Innesti Faccia Piana
Flachdichtend
Clapet à Face Plat

Flat Face
Innesti Faccia Piana
Flachdichtend
Clapet à Face Plat

Multifaster
Multiconessioni
Multikupplungen
Multifaster

Multifaster
Multiconessioni
Multikupplungen
Multifaster

Accessories - Accessori - Zubehör - Accessoires

Size Base BG Taille	Dust protections Tappi Protezione Staubschutzteile Capuchons		PVC	Part Number Codice Articolo Artikelnummer Désignation	
	mm	inch.			
10	3/8"	TF 38			
12.5	1/2"	TF 2FI 12			
19	3/4"	TF 2FI 34			

Thread Filetto Anschluss Filetage	



Features	Caratteristiche	Merkmale	Caractéristiques
Connexion by pushing the male coupling	Connessione spingendo la parte maschio	Kuppeln durch Einstecken des Kupplungssteckers	Connexion en poussant le coupleur mâle
Disconnexion by pulling back the female sleeve	Disconnessione mediante arretramento ghiera parte femmina	Entkuppeln, durch Zurückziehen der Verriegelungshülse	Déconnexion en en tirant la bague femelle
Shut off by flat valve	Sistema di tenuta mediante valvola piana	Verschluss durch flachdichtendes Ventil	Clapet à Face Plate
Connexion under pressure using 3FFH Series	Connessione in pressione usando la Serie 3FFH	Kuppeln unter Druck mit 3FFH Steckern	Connexion sous pression avec la série 3FFH
Disconnexion under pressure in 2 steps	Disconnessione in pressione in due fasi	Entkuppeln unter Druck in 2 Schritten	Déconnexion sous pression en deux étapes
Interchangeability according to ISO 16028	Intercambiabilità secondo norme ISO 16028	Austauschbarkeit gemäß ISO 16028 Standard	Interchangeabilité selon ISO 16028
No spillage during Connexion and Disconnexion	Assenza di spillaggio durante connessione e disconnessione	Kein Leckage während des Kuppel und Entkuppelvorgangs	Pas de fuites lors de la connexion et la déconnexion
Same fixing points as 4BD4FI block	Punti di fissaggio come blocco 4BD4FI	Identische Befestigungsbohrungen wie Block 4BD4FI	Points de fixation identique bloc 4BD4FI

Fields of application
Settori di applicazione
Anwendungsbereiche
Domaines d'application



Size Base BG Taille	Max working pressure Max pressione di esercizio Betriebsdruck Pression de service	Flow Rate Portata Durchflussmenge Débit	Min burst pressures Min pressione di scoppio Berstdruck Pression d'éclatement
		@ 0,2 MPa pressure drop	
mm inch	MPa (PSI)	MPa (PSI)	MPa (PSI)
12.5 1/2"	35 (5075)	100 (26.4)	125 (18125) 125 (18125)
20 3/4"	35 (5075)	145 (38.3)	125 (18125) 125 (18125)

Technical Specifications	Specifiche Tecniche	Technische Daten	Caractéristiques Techniques
FEMALE: high grade steel carbonitrided wearing parts. MALE: high grade carbon steel induction hardened.	FEMMINA: in acciaio con parti sollecitate carbonitrate. MASCHIO: in acciaio al carbonio temprato ad induzione	MUFFE: Hochwehrtiger Karbonnitritstahl in besonders beanspruchten Zonen. STECKER: Hochwehrtiger Karbonstahl induktionsgehärtet	FEMELLE: Acier avec les zones d'usure. MALE: acier à haute teneur trempés par induction
Polyurethane and NBR Backup ring in PTFE	Polyuretano e NBR Anello antiestrusione PTFE	Polyurethan und NBR Stützring in PTFE	Polyuréthane et NBR Anneau anti-extrusion en PTFE
-25°C to +100°C (-13°F to +212°F)	-25°C a +100°C (-13°F a +212°F)	-25°C to +100°C (-13°F to +212°F)	-25°C à +100°C (-13°F à +212°F)
Mate500® Mate1000®	Mate500® Mate1000®	Mate500® Mate1000®	Mate500® Mate1000®
According to ISO 7241-2	Secondo la norma ISO 7241-2	Nach ISO 7241-2	Selon la norme ISO 7241-2

4BD4FH

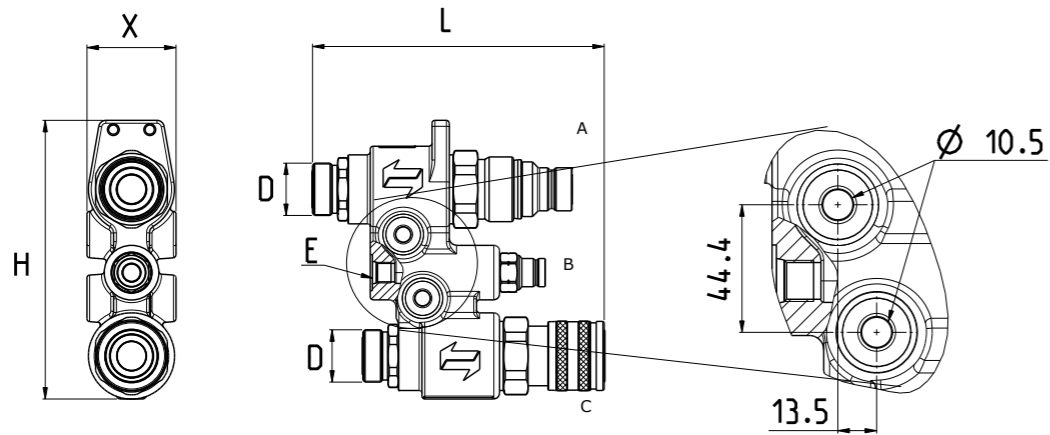

Configuration - Configurazione - Konfiguration - Configuration

Size Base BG Taille	Thread Filetto Anschluss Filetage	Part Number Codice Articolo Artikelnummer Désignation	D	E	L	H	X	Weight Peso Gewicht Poids	Package Confezione Verpackung Colis
mm inch					mm (in)	mm (in)	mm (in)	g (lbs)	No.
12.5 1/2"	F	4BD4FH08-11/12S		9/16" - 18 UNF 2B Female	179 (7.05)	194 (7.64)	62 (2.44)		
12.5 1/2"	F	4BD4FH08-11/34S		9/16" - 18 UNF 2B Female	202 (7.95)	194 (7.64)	62 (2.44)		
12.5 1/2"	F	4BD4FH08-13/34S		9/16" - 18 UNF 2B Female	188 (7.40)	194 (7.64)	62 (2.44)		
12.5 1/2"	11/	4BD4FH08-11/12S	13/16"-16 UN 2A Male	-	179 (7.05)	194 (7.64)	62 (2.44)		
12.5 1/2"	11/	4BD4FH08-11/34S	1-3/16"-12 UN 2A Male	-	202 (7.95)	194 (7.64)	62 (2.44)		
12.5 1/2"	13/	4BD4FH08-13/34S	1-1/16"-12 UN 2A Male	-	188 (7.40)	194 (7.64)	62 (2.44)		
20 3/4"	F	4BD4FH12-11/12S		9/16" - 18 UNF 2B Female	199 (7.83)	194 (7.64)	62 (2.44)		
20 3/4"	F	4BD4FH12-11/34S		9/16" - 18 UNF 2B Female	203 (7.99)	194 (7.64)	62 (2.44)		
20 3/4"	F	4BD4FH12-13/34S		9/16" - 18 UNF 2B Female	189 (7.44)	194 (7.64)	62 (2.44)		
20 3/4"	11/	4BD4FH12-11/12S	13/16"-16 UN 2A Male		199 (7.83)	194 (7.64)	62 (2.44)		
20 3/4"	11/	4BD4FH12-11/34S	1-3/16"-12 UN 2A Male		203 (7.99)	194 (7.64)	62 (2.44)		
20 3/4"	13/	4BD4FH12-13/34S	1-1/16"-12 UN 2A Male		189 (7.44)	194 (7.64)	62 (2.44)		

Accessories - Accessori - Zubehör - Accessoires

Size Base BG Taille	Part Number Codice Articolo Artikelnummer Désignation
mm inch	
10 3/8"	KIT 4BD-FFH06M
12.5 1/2"	KIT 4FH08 M
12.5 1/2"	KIT 4FH08 M
20 3/4"	KIT 4FH12 M
20 3/4"	KIT 4FH12 M

Thread Filetto Anschluss Filetage

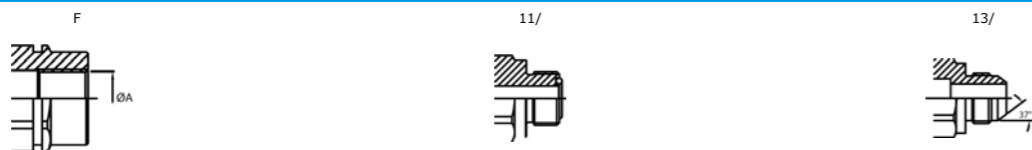

Identification Guide - Guida Identificativa Bestimmungsführer - Guide d'identification

Reference Riferimento Bezeichnung Référence

Mobile Half Piastra Mobile Mobilteil Partie Mobile

M

KIT3FNP...
KIT3FNP...
KIT3FNP...

Reference Riferimento Bezeichnung Référence

Mobile Half Piastra Mobile Mobilteil Partie Mobile

M

KIT2FNP...
KIT2FNP...
KIT2FNP...
KIT2FNP...

Model Modello Modell Modèle

PB - PS - P2
P5 - P6 - P8

Size Base BG Taille

06=3/8"
08=1/2"
10=1/2"+3/4"

Reference Riferimento Bezeichnung Référence

Fixed Half Piastra Fissa Fixteil Partie Fixe

L

KIT2FNB...
KIT2FNB...
KIT2FNB...
KIT2FNB...

Thread Filetto Anschluß Filetage

...12 GAS = 1/2" BSP
...12 NPT = 1/2" NPT
...12 SAE = 34-16 UNF
...34 GAS = 3/4" BSP
...2/2215 = M22x1.5